

UNI-Dispenser



Manufactured by Asept International AB
Traktorvägen 17
S-226 60 Lund, Sweden

Tel: +46 46 329700
Fax: +46 46 329710
E-mail: info@asept.se
www.asept.com

ASEPT

ASEPT
www.asept.com

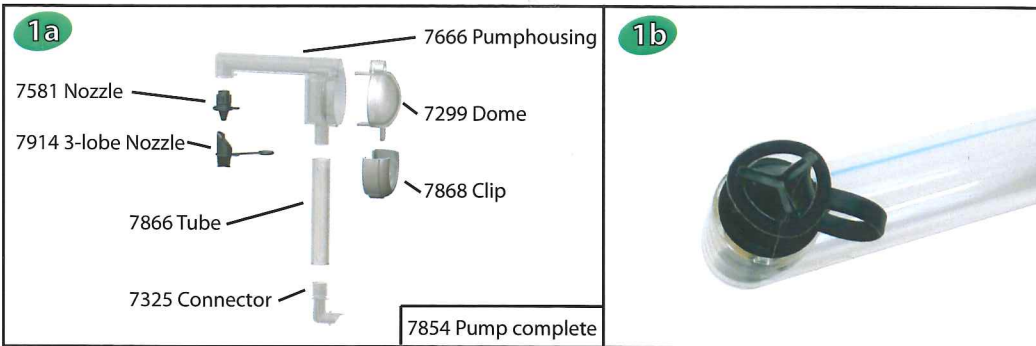

1. Assembling the pump

Wash the complete pump before first time use.

Push the Dome (7299) into the Pumphousing (7666). Moisten the dome in order to make the assembly easier. Make sure the dome is pushed all the way into the pumphousing. When pumping very thick and oily products (e.g. mayonnaise), the dome may start sliding out of the pumphousing, due to the increased pressure build-up inside the pumphousing. However, this can be prevented by using the optional Clip (7868). Attach the Clip by sliding it around the dome and part of the pumphousing, starting from the inlet-side, making sure that the tab of the dome goes into the slot of the Clip. Push the Tube (7866) on to the tube of the pumphousing. Make sure the pins of the pumphousing catch the notches of the hose. Push the Connector (7325) on to the tube. The pump comes with either the 3-lobe Nozzle (7914) or the Nozzle (7581) or both. Put the appropriate nozzle into the spout of the pumphousing. Then fasten the loop of the nozzle to the pin of the pumphousing. For pumping thick products (e.g. mayonnaise) the opening of the Nozzle (7581) can be increased by cutting off the tip of nozzle. To prevent dripping from the 3-lobe Nozzle, put the o-ring into the three notches of the nozzle (see picture 1b).



2. Connecting the pouch

Put a new pouch on a flat surface. Locate the fitment. Place the connector of the pump in the centre of the fitment. Firmly push the connector into the fitment until it snaps in place.



3. Inserting the pouch

Hold the pump and the pouch with both hands. Let the pouch slide into the container and guide the pump-housing into the slots inside the container.

4. Using the pouch clips

Rake down the product of the upper end of the pouch. Put the lip of the pouch into the two clips inside the container and then close the clips. This will locate the pouch in an upright position while being emptied, to ensure a good product-yield.

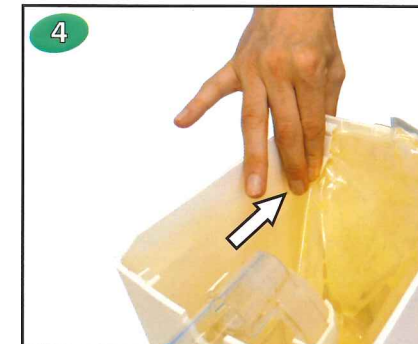

5. Attaching the lid

To attach the lid, guide the two pegs of the inside of the front wall of the container into the corresponding holes of the lid. Then put the back of the lid in place, guiding the snap-catch into its proper position.



6. Removing the lid

Remove the lid by pressing on the lip on the back and then tilting it forward.

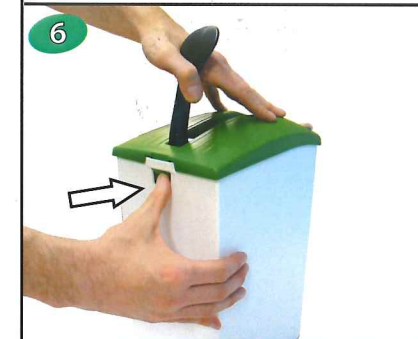

7. Cleaning

Detach the dome from the pumphousing by pulling the flap of the dome. Twist and pull the hose off from the pumphousing and the connector. Pull the nozzle out of the pumphousing. Wash the parts by hand, using ordinary detergent. Reassemble according to the instruction "1. Assembling the pump"

